

# 3362 - 1/4 " Square Trimming Potentiometer

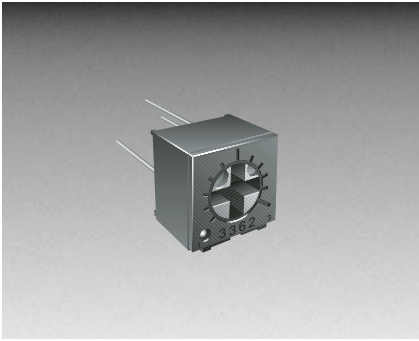

## Electrical Characteristics

- Standard Resistance Range  
 ..... 10 to 2 megohms  
 (see standard resistance table)
- Resistance Tolerance ..... ±10 % std.  
 (tighter tolerance available)
- Absolute Minimum Resistance  
 ..... 1 % or 2 ohms  
 (whichever is greater)
- Contact Resistance Variation  
 ..... 1 % or 3 ohms max.  
 (whichever is greater)
- Adjustability  
 Voltage ..... ±0.05 %  
 Resistance ..... ±0.15 %
- Resolution ..... Infinite
- Insulation Resistance ..... 500 vdc.  
 1,000 megohms min.
- Dielectric Strength  
 Sea Level ..... 900 vac  
 80,000 Feet ..... 350 vac
- Adjustment Angle ..... 240 ° nom.

## Environmental Characteristics

- Power Rating (300 volts max.)  
 70 °C ..... 0.50 watt  
 125 °C ..... 0 watt
- Temperature Range  
 ..... -55 °C to +125 °C
- Temperature Coefficient  
 ..... ±100 ppm/°C
- Seal Test ..... 85 °C Fluorinert
- Humidity ..... MIL-STD-202 Method 103  
 96 hours  
 (2 % ΔTR; 10 Megohms IR)
- Vibration ..... 30 G (1 % ΔTR; 1 % ΔVR)
- Shock ..... 100 G (1 % ΔTR; 1 % ΔVR)
- Load Life .. 1,000 hours 0.5 watt @ 70 °C  
 (3 % ΔTR; 3 % or 3 ohms,  
 whichever is greater, CRV)
- Rotational Life ..... 200 cycles  
 (4 % ΔTR; 3 % or 3 ohms,  
 whichever is greater, CRV)

## Physical Characteristics

- Mechanical Angle ..... 270 ° nom.
- Torque ..... 3.0 oz-in. max.
- Stop Strength ..... 7.0 oz-in. min.
- Terminals ..... Solderable pins
- Weight ..... 0.02 oz.
- Marking ..... Resistance code,  
 terminal numbers, manufacturer's  
 model number, style  
 and date code
- Wiper ..... 50 % (Actual TR) ±10 %
- Flammability ..... U.L. 94V-0
- Standard Packaging ..... 50 pcs. per tube
- Adjustment Tool ..... H-90

## Common Dimensions Top Adjust

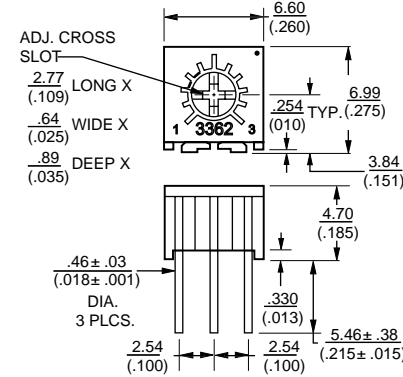

## 3362H

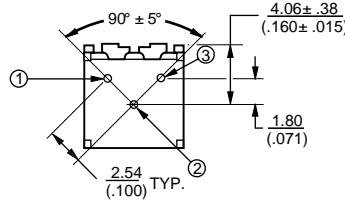

## 3362P

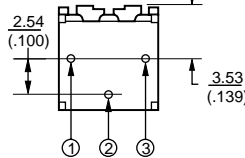

## 3362R

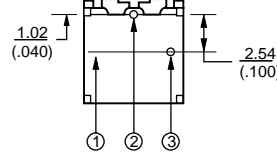

TOLERANCES: ±0.25 (.010) EXCEPT WHERE NOTED

DIMENSIONS ARE: MM  
(INCHES)

## How to Order

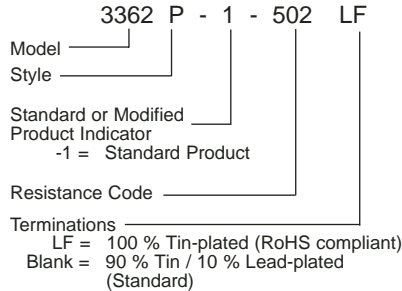

## Common Dimensions Side Adjust

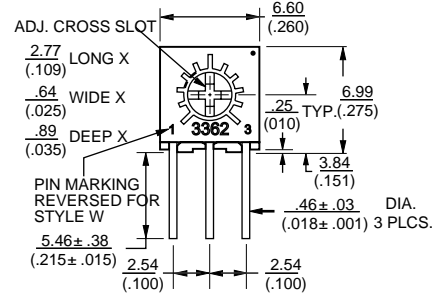

## 3362M

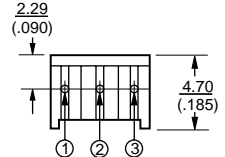

## 3362S

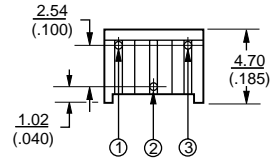

## 3362W

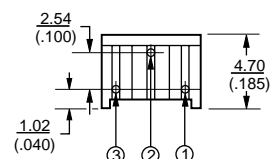

## 3362X

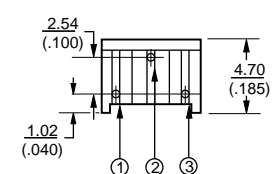

## Standard Resistance Table

Resistance (Ohms)	Resistance Code
10	100
20	200
50	500
100	101
200	201
500	501
1,000	102
2,000	202
5,000	502
10,000	103
20,000	203
25,000	253
50,000	503
100,000	104
200,000	204
250,000	254
500,000	504
1,000,000	105
2,000,000	205

Popular distribution resistance values listed in boldface. Special resistances available.