

AR111-30B54-12V Warm White

Unit : mm

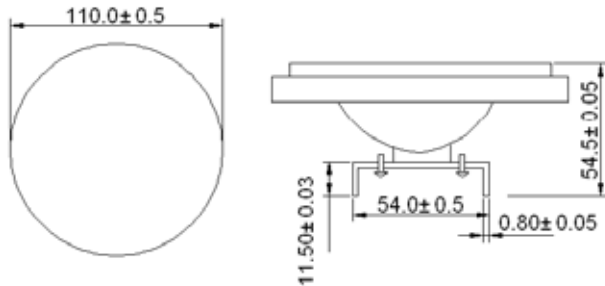

Electrical and optical characteristics (Ta = 25°C)

| Parameters | Sym- bol | Values | | | Unit |
|-------------------------|-------------|--|----------|-----|----------|
| | | MIN | TYP | MAX | |
| Input Voltage | V_{in} | 10 | 12 AC/DC | 24 | V_{DC} |
| Input Current | I_{in} | 130 | 330 | 400 | mA |
| Oscillation Frequency | f | suitable for Industrial Frequency Transformer or High Frequency Electronic Transformer | | | Hz |
| Power Consumption (MAX) | P | 4.2 | | | W |
| LED QTY | - | 30 | | | PCS |
| CCT | - | 3000 | | | K |
| Lumunous flux (MAX) | - | 340-350 lum | | | Lm |
| Operating Temperature | T_{opr} | -20 | 25 | 40 | °C |

Light Source Test Report

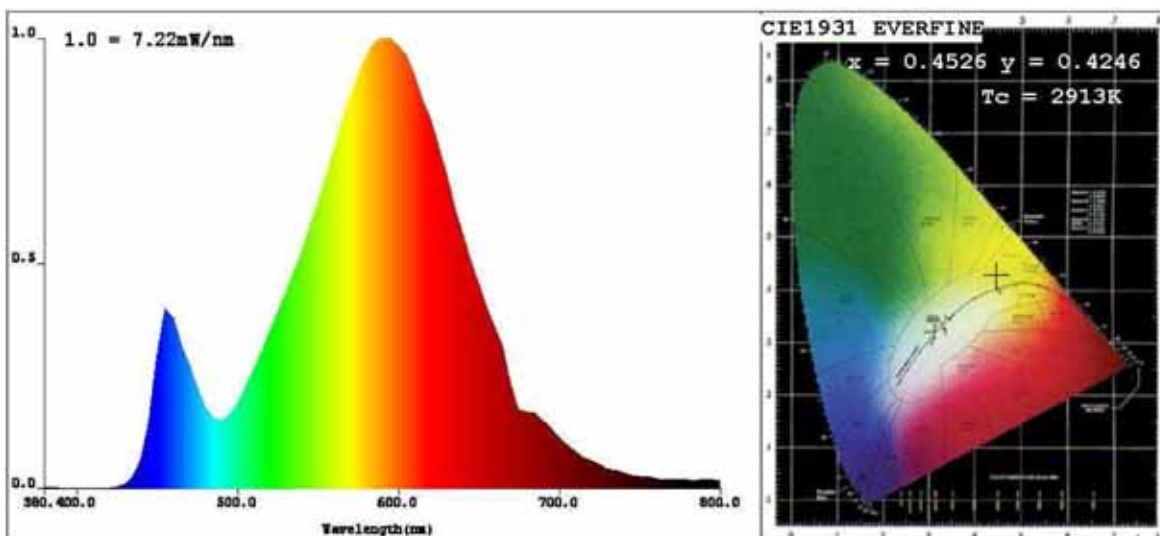

CIE Color Parameters:

Chromaticity Coordinate: $x=0.4526$ $y=0.4246$ / $u'=0.2518$ $v'=0.5315$ ($duv=5.91e-003$)

CCT: $T_c=2913K$ Prcp WaveL: $\lambda=581.4nm$ Purity= 63.3%

Peak WaveL: $\lambda=595nm$ Half Width: $\lambda=108.2nm$ Ratio: R= 21.1% G= 76.9% B= 2.0%

Average Wave: $588nm$

Rendering Index: $R_a=96.4$

R1=64 R2=82 R3=95 R4=61 R5=63 R6=74 R7=77 R8=38

R9=0 R10=59 R11=53 R12=42 R13=68 R14=98 R15=56

Photo Parameters:

Flux: $\phi=343.75(lm)$ Luminous Efficacy: $82.48(lm/W)$ Luminous Power: $P=947.7(mW)$

Electrical Parameters:

U= $12.08V$ I= $0.3450A$ P= $4.168W$ PF= 1.000

Instrument Status:

Scan Range: $380.0nm-800.0nm$

REF= 22138

Interval: $5.0nm$

TMP(PMT)= $32.3degrees$ centigrade

Ip= 11416 (G=4, D=60)

Test Mode: Fast Test