

ARPV-LV24005 (24V, 0,2A, 5W)

Features:

- Constant voltage mode power supply
- Universal AC input / Full range
- Fully encapsulated with IP67 level
- Protections: Over current/ Over Voltage
- Small and compact size
- UL1310 Class 2 power unit
- 100% full load burn-in test
- Suitable for LED lighting and moving sign applications
- 2 years warranty



Specification:

OUTPUT	DC VOLTAGE	24V
	RATED CURRENT	0.2
	CURRENT RANGE	0~0.2A
	RATED POWER	5W
	RIPPLE & NOISE (max.)	200mVp-p
	VOLTAGE TOLERANCE	±3.0%
	LINE REGULATION	±1.0%
	LOAD REGULATION	±2.0%
	SETUP,RISE TIME	500ms,250ms, 50ms/230VAC
INPUT	VOLTAGE RANGE	100-240VAC
	FREQUENCY RANGE	47~63Hz
	EFFICIENCY(Typ.)	78% full load
	AC CURRENT(at full load)	0.15A/100AC 0.10A/240VAC
	INRUSH CURRENT (max.)	COLD STAT 30A/240VAC
	LEAKAGE CURRENT	0.5mA/240VAC
PROTECTION	OVER CURRENT	Above 110%~180% rated output power or short circuit. Protection type: Hiccup mode, recovers automatically after fault condition is removed.
	OVER VOLTAGE	--
ENVIRONMENT	WORKING TEMP.	-10~+50°C
	WORKING HUMIDITY	20~90% RH non-condensing
	STORAGE TEMP., HUMIDITY	-40~+80°C, 10~95% RH
	TEMP.COEFFICIENT	±0.03%/°C (0~50°C)
	VIBRATION	10 ~ 500Hz, 2G 10min./1cycle, period for 60min. each along X,Y,Z axes

SAFETY & EMC	SAFETY STANDARDS	Design refer to UL1310 Class 2,TUV EN60950-1, EN61347-2-13, CAN/CSA C22.2 No. 223-M91, meet IP67
	WITHSTAND VOLTAGE	I/P-O/P:3KVAC
	ISOLATION RESISTANCE	I/P-O/P:>100M Ohms / 500VDC / 25~70% RH
	EMI CONDUCTION & RADIATION	Compliance to EN55022 (CISPR22) Class B
	HARMONIC CURRENT	Compliance to EN61000-3-2,-3
	EMS IMMUNITY	Compliance to EN61000-4-2,3,4,5,6,8,11; ENV50204, EN55024, light industry level, criteria A
DIMENSION		59*28*22mm (L*W*H)

Mechanical Specification:

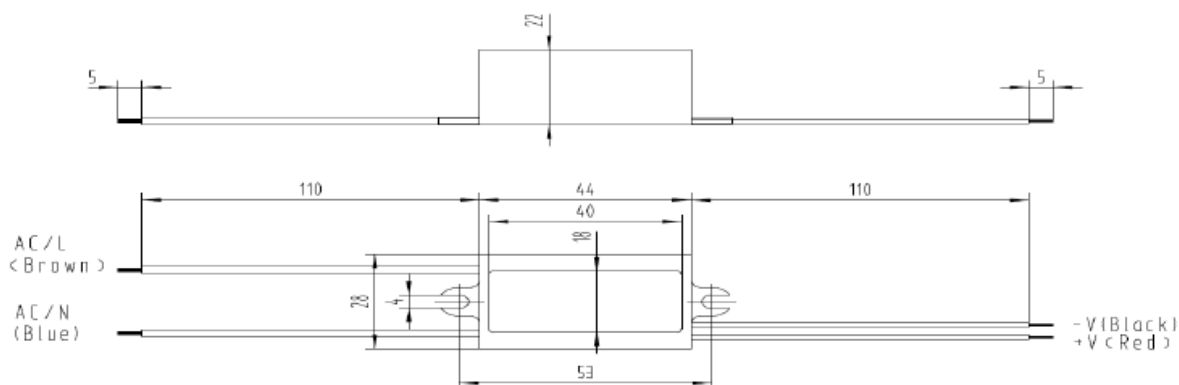

Block Diagram:

