

OS-1W White 10V (120mA, 6000K)

Features:

1. Highest Luminous Flux
2. Super Energy Efficiency
3. Long Lifetime Operation
4. Superior UV Resistance



Applications:

1. Read lights (car, bus, aircraft)
2. Portable (flashlight, bicycle)
3. Bollards / Security / Garden
4. Traffic signaling / Beacons
5. Indoor / Outdoor Commercial lights
6. Automotive Ext

Directivity:

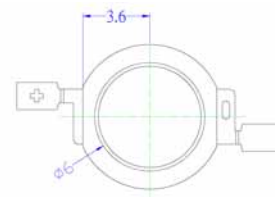
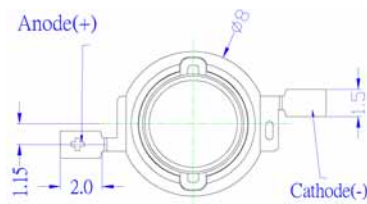
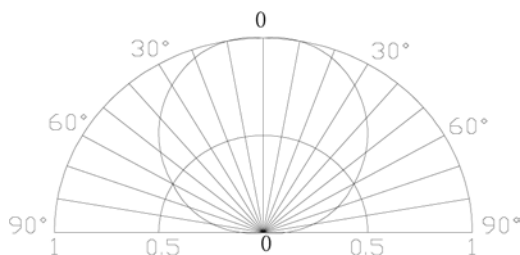

BackView

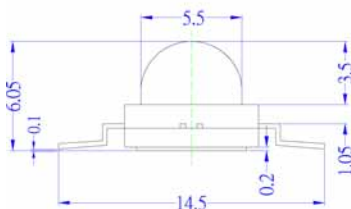

Anode • → → → • Cathode

Unit:mm
Tolerance:±0.30mm

Absolute Maximum Ratings (Ta=25°C):

Parameter	Symbol	Value	Unit
DC Forward Current	I_F	150	mA
Pulse Forward Current*	I_{FP}	300	mA
Reverse Voltage	V_R	5	V
Power Dissipation	P_D	1710	mW
Operating Temperature	T_{opr}	-30 ~ +85	°C
Storage Temperature	T_{stg}	-40 ~ +100	°C
Lead Soldering Temperature	T_{sol}	260°C/5sec	°C

*Pulse width Max.10ms Duty ratio max 1/10

Electrical-Optical Characteristics (Ta=25°C)

Item	Symbol	Condition	Min.	Typ.	Max.	Unit
DC Forward Voltage	V_F	$I_F=120mA$	9.0	9.6	11.4	V
DC Reverse Current	I_R	$V_R=5V$	-	-	10	μA
Luminous Flux	Φ_v	$I_F=120mA$	80	90	-	lm
Color Temperature	CCT	$I_F=120mA$	-	6500	-	K
Chromaticity Coordinates*	x	$I_F=120mA$	-	0.31	-	-
	y	$I_F=120mA$	-	0.33	-	-
50% Power Angle	$2\theta_{1/2}$	$I_F=120mA$	-	120	-	deg

NOTE: Don't drive at rated current more than 5s without heat sink for Xeon 3 emitter series.