

# SPECIFICATION FOR APPROVAL

REF :

PAGE: 1

PROD. NAME	LINE FILTER	ABC'S DWG NO. ABC'S ITEM NO.	UF10□□□□□□L□
---------------	-------------	---------------------------------	--------------

**. CONFIGURATION & DIMENSIONS :**

●UF10V2 Series

Marking:

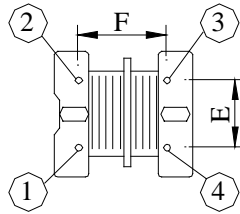
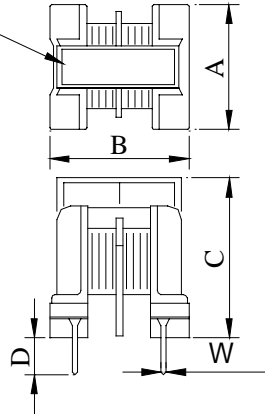
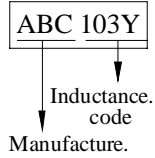

A :	17.0 max.	m/m
B :	19.0 max.	m/m
C :	22.5 max.	m/m
D :	4.5±1	m/m
E :	10.0±0.5	m/m
F :	13.0±0.5	m/m
W :	0.7	m/m

●UF10V4 Series

Marking:

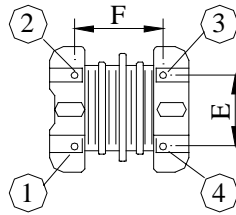
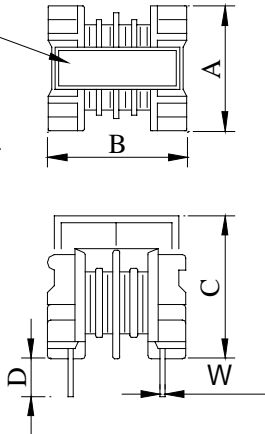
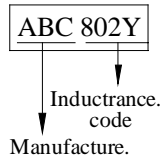

A :	17.0 max.	m/m
B :	19.0 max.	m/m
C :	20.5 max.	m/m
D :	4.5±1	m/m
E :	10.0±0.5	m/m
F :	13.0±0.5	m/m
W :	0.7	m/m

**. SCHEMATIC DIAGRAM :**

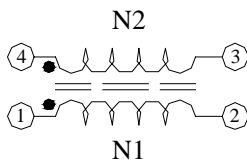

"●" : Polarity

**. MATERIALS :**

- a . Core : Ferrite UU core
- b . Bobbin : Phenolic
- c . Wire : Enamelled copper wire (Class F)
- d . Clip : High carbon steel
- e . Coating : Varnish
- f . Remark : Lead content 200ppm max. include ferrite

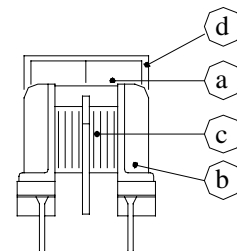

# SPECIFICATION FOR APPROVAL

REF :

PAGE: 2

PROD. NAME	LINE FILTER	ABC'S DWG NO.	UF10□□□□□□L□
		ABC'S ITEM NO.	

**. GENERAL SPECIFICATION :**

- a . Temp. rise : 40 max. at rated current
- b . Storage temp. : -40 ---- +105
- c . Operating temp. : -25 ---- +85
- d . Pin strength : 1.0KG min.

**. ELECTRICAL CHARACTERISTICS :**

DWG No.	L (mH) min.	RDC (Ω) max.	Rated Current (Aac)
UF10V2103YL□	10.0	2.5	0.4
UF10V2802YL□	8.0	1.7	0.5
UF10V2502YL□	5.0	1.0	0.7
UF10V2302YL□	3.0	0.5	0.8
UF10V2202YL□	2.0	0.4	1.0
UF10V2102YL□	1.0	0.2	1.6

DWG No.	L (mH) min.	RDC (Ω) max.	Rated Current (Aac)
UF10V4802YL□	8.0	2.4	0.4
UF10V4502YL□	5.0	1.5	0.5
UF10V4402YL□	4.0	1.0	0.7
UF10V4252YL□	2.5	0.5	0.8
UF10V4162YL□	1.6	0.4	1.0
UF10V4801YL□	0.8	0.2	1.6

1). □ : Packaging information... A : Bulk

1). □ : Packaging information... A : Bulk

**. IMPEDANCE VS FREQUENCY CURVE :**

●UF10V2 Series

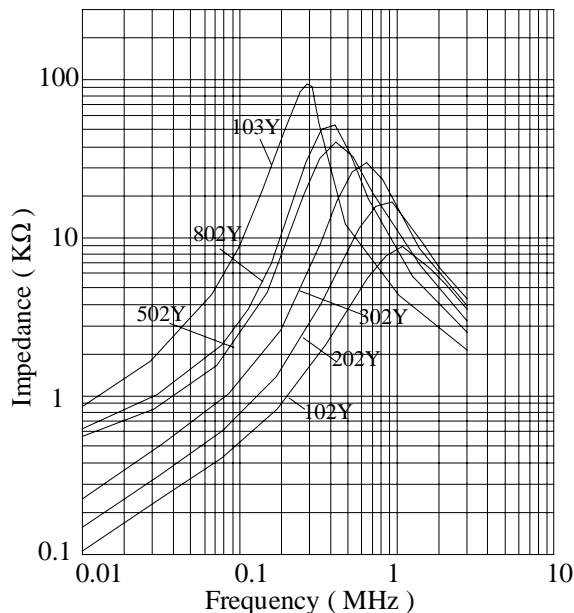

●UF10V4 Series

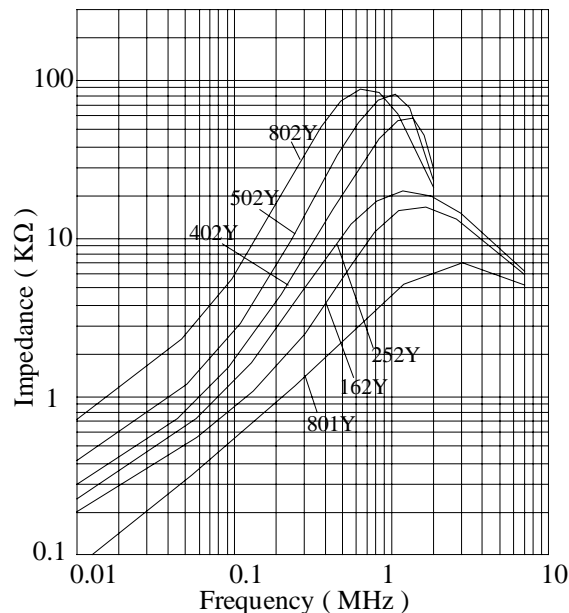

●IMPEDANCE MEASURING CIRCUIT :

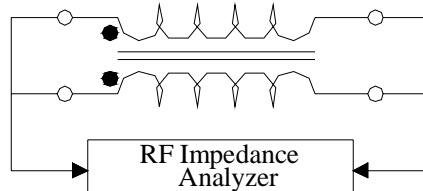

AE-001A

# SPECIFICATION FOR APPROVAL

REF :

PAGE: 2

PROD. NAME	LINE FILTER	ABC'S DWG NO. ABC'S ITEM NO.	UF10□□□□□□L□
---------------	-------------	---------------------------------	--------------

**. GENERAL SPECIFICATION :**

- a . Temp. rise : 40 max. at rated current
- b . Storage temp. : -40 ---- +105
- c . Operating temp. : -25 ---- +85
- d . Pin strength : 1.0KG min.

**. ELECTRICAL CHARACTERISTICS :**

DWG No.	L (mH) min.	RDC (Ω) max.	Rated Current (Aac)
UF10V2103YL□	10.0	2.5	0.4
UF10V2802YL□	8.0	1.7	0.5
UF10V2502YL□	5.0	1.0	0.7
UF10V2302YL□	3.0	0.5	0.8
UF10V2202YL□	2.0	0.4	1.0
UF10V2102YL□	1.0	0.2	1.6

DWG No.	L (mH) min.	RDC (Ω) max.	Rated Current (Aac)
UF10V4802YL□	8.0	2.4	0.4
UF10V4502YL□	5.0	1.5	0.5
UF10V4402YL□	4.0	1.0	0.7
UF10V4252YL□	2.5	0.5	0.8
UF10V4162YL□	1.6	0.4	1.0
UF10V4801YL□	0.8	0.2	1.6

1). □ : Packaging information... **A** : Bulk

1). □ : Packaging information... **A** : Bulk

**. IMPEDANCE VS FREQUENCY CURVE :**

●UF10V2 Series

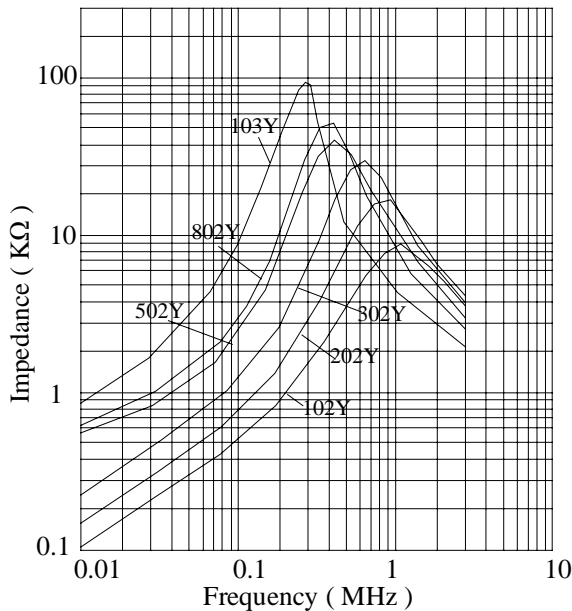

●UF10V4 Series

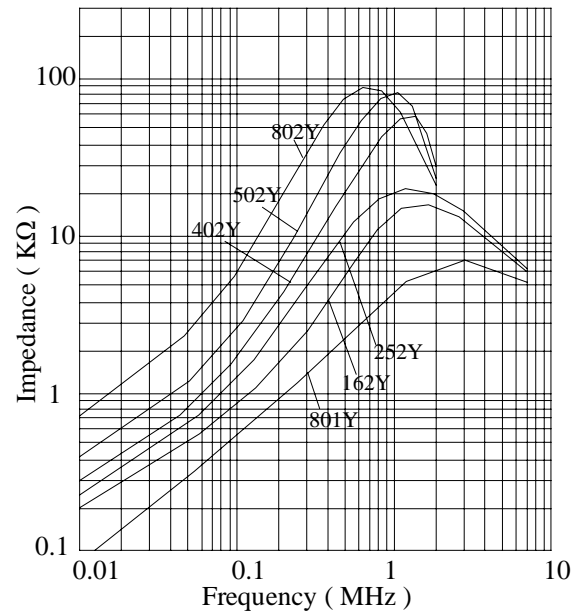

**●IMPEDANCE MEASURING CIRCUIT :**

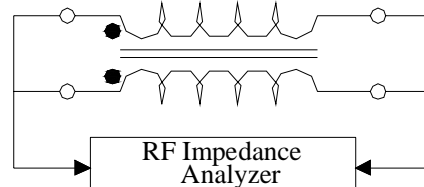

AE-001A

# SPECIFICATION FOR APPROVAL

REF :

PAGE: 4

PROD. NAME	LINE FILTER	ABC'S DWG NO.	UF10□□□□□□L□
		ABC'S ITEM NO.	

UL CARD :

OBMW2 September 8, 2000  
Magnet Wire-Component  
JUNG SHING WIRE CO LTD E174837  
231 CHUNG CHENG RD, SEC 3 JEN-TEH HSIANG, TAINAN  
HSIEN TAIWAN

Mtl Dsg	Mark Dsg	BC	Coat Typ	OC	ANSI Type	Temp Class
AIW	---	Polyamideimide	---	---	MW81-C	220
CFUEWB	---	Polyurethane	---	---	MW75C	130
EIAIW	---	Polyesterimide	Polyamideimide	---	MW35C	200
EILOCKY	---	Polyesterimide	Polyamide	---	---	180
EILOCKW	---	Polyesterimide	Modified Epoxy	---	---	200
EIW	---	Polyesterimide	---	---	---	220
EIW-2	---	Polyesterimide	---	---	MW74-C	200
FL.EILOCKY	---	Modified Polyester	Polyamide	---	---	155
LSFFW	---	Polyurethane	---	---	MW79-C	155
LSUEW	---	Polyurethane	---	---	---	130
PEW	---	Polyester	---	---	---	155
PEY	---	Polyester	Nylon	---	MW24-C	155
SF.FLW	---	Modified Polyester	---	---	MW26C	155
SF.EIW	---	Polyesterimide	---	---	MW77C	180
SF.BY@	---	Modified Polyester	Nylon	---	MW27-C	155
SF.FLY@	---	Modified Polyester	Nylon	---	MW27-C	155
SF.BLOCKBS	---	Modified Polyester	Modified Polyamide	---	---	155
SF.EILOCKY#	---	Polyesterimide	Polyamide	---	---	180
SF.EILOCKBS	---	Polyesterimide	Modified Polyamide	---	---	180
SF.BW@	---	Modified Polyester	---	---	MW26C	155
SFFW	---	Polyurethane	---	---	MW79	155

287806002 Page 1 of 2

Mtl Dsg	Mark Dsg	BC	Coat Typ	OC	ANSI Type	Temp Class
SFFY	---	Polyurethane	---	Polyamide	MW80C	155
UEW-1	---	Polyurethane	---	---	MW2-C	105
UEW-2	---	Polyurethane	---	---	---	130
UEW-4	---	Polyurethane	---	---	MW75C	130
UEY	---	Polyurethane	Nylon	---	MW28-C	130
UEY-2	---	Polyurethane	Polyamide	---	MW28-C	130

287806002 Page 2 of 2

OBMW2E174837  
September 8, 2000

A not-for-profit organization dedicated to public safety and committed to quality service

@ - May be suffixed by LZ; # - May be suffixed by LZ, EL or LZI.  
LZ - Signifies magnet wires twisted together; EL - signifies base coated magnet wire laid parallel with top coat applied overall; LZL - signifies base coated magnet wire twisted together and covered with top coat overall.  
Marking: Company name or trademarks JSW or 榮星電線, material designation or marked designation on packed or reel, and Recognized Component Mark.  
See General Information Preceding These Recognitions  
For use only in equipment where the acceptability of the combination is determined by Underwriters Laboratories Inc.

AE-001A



# SPECIFICATION FOR APPROVAL

REF :

PAGE: 5

PROD. NAME	LINE FILTER	ABC'S DWG NO. ABC'S ITEM NO.	UF10□□□□□□L□
---------------	-------------	---------------------------------	--------------

QMFZ2		March 4, 1994										
Component - Plastics												
CHANG CHUN PLASTICS CO LTD		E59481(S)										
		(C--cont. From B card)										
T355J	BK	0.62	94V-0	150	150	150	1	0	2	6	3	
		0.80	94V-0	150	150	150	1	0	2	6	3	
		1.00	94V-0	150	150	150	1	0	2	6	3	
T359J	BK,BN	0.79	94HB	150	150	150	1	0	4	7	4	
	NC	1.57	94HB	150	150	150	1	0	4	7	4	
	(a)	3.17	94HB	150	150	150	0	0	4	7	4	
T373J	BK,BN	1.00	94V-1	150	150	150	2	0	3	6	4	
		1.00	94V-0	150	150	150	2	0	3	6	4	
		2.00	94V-0	150	150	150	1	0	3	6	4	
T375J	BK,BN	0.79	94V-0	150	150	150	1	0	4	5	4	
		1.58	94V-0	150	150	150	0	0	4	5	4	
		3.17	94V-0	150	150	150	0	0	4	5	4	
T377J	BK	0.79	94HB	150	150	150	2	0	4	7	4	
		1.58	94HB	150	150	150	1	0	4	7	4	
		3.17	94HB	150	150	150	0	0	4	7	4	
Report: January 6, 1976.												
Replaces E59481C dated February 7, 1989.		(Cont. on CIF card)										
262854001	N7047	Underwriters Laboratories Inc.®							D11/0018965			

OBOR2		January 12, 1996										
Component-Varnishes												
JOHN C DOLPH CO		E51047 (M)										
320 NEW RD PO BOX 267, MONMOUTH		(A card)										
JUNCTION NJ 08852												
Varnish	ANSI			Varnish								
Dag	Magnet	Wire Type	Wire Type	Wire Type	Wire Type	Wire Type	Wire Type	Wire Type	Wire Type	Wire Type	Wire Type	
AC-43		MW28	MW24	MW35	MW28	MW35	MW24	MW35	MW28	MW35	MW24	
EB-43-FB												
AC-43-66												
BB-353												
BC-326												
Report: June 20, 1980.												
Replaces E51047A dated September 18, 1994.		(Cont. on A005 card)										
452548001	H0767	Underwriters Laboratories Inc.®							D11/0025721			
											34	

AE-001A

