



- * Product Name: Rocker Switch;
- * Model No: YSR-7 (8)
- * Voltage Resistance: 2000VAC, 1MIN;
- * Operating Temperature: T85 T105
- * Electrical Life: more than 10,000cycles
- * Contact Rating: UL、CUL:

3/6A	250/125VAC,	5/10A	250/125VAC
6.5/13A	250/125VAC,	10/15A	250/125VAC
16/20A	250/125VAC,	1/2HP	125VAC
- VDE:

3 (1) A	250V ~ ,	6 (2) A	250V ~
10 (4) A	250V ~		



KNOB COLOR	BLACK; RED; GREEN; ORANGE; BLUE; ...		
BASE COLOR	GRAY; BLACK; WHITE; ...		
KNOB SHAPE	TYPE C:	Unilluminate	YSR-7-21 (8) 2P1T 4P
Illuminate	YSR-7-21 (8) /N 2P1T 4P		YSR-7-22 (8) 2P2T 6P YSR-7-23 (8) 2P2T 6P

Wiring Diagram

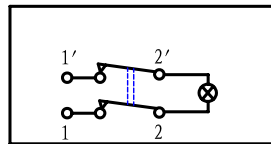

On-Off (Illuminate)

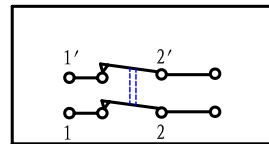

On-Off (Unilluminate)

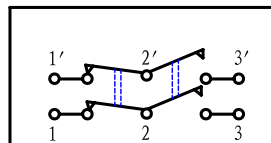

On-On (Unilluminate)

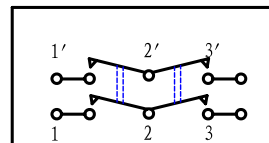

On-Off-On (Unilluminate)

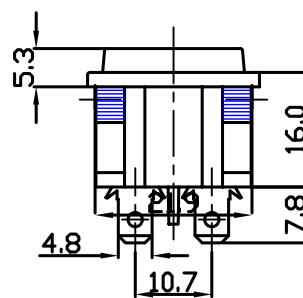
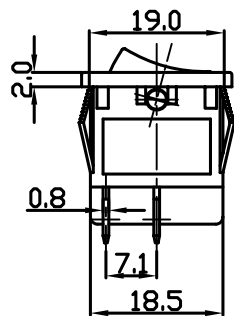

Panel Installation Size

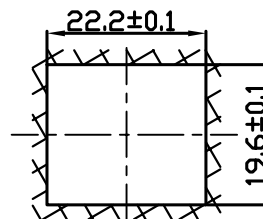
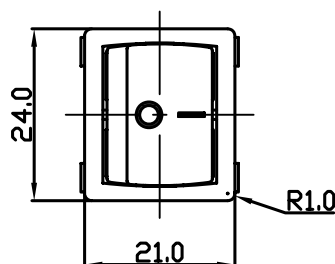

Panel Installation
Thickness 1 ~ 4mm